



# TRAC-MASTER®

Avant Garde

## CYLINDRA™ SERIES

T841, T844, T845 and T846

Project: \_\_\_\_\_

Fixture Type: \_\_\_\_\_

Location: \_\_\_\_\_

Contact/Phone: \_\_\_\_\_

### PRODUCT DESCRIPTION

The contemporary styling of the Cylindra fixture enables it to subtly enhance practically any decor without diverting attention from the surrounding environment. Soft curved surfaces combine with clean, crisp edges to provide a uniquely attractive aesthetic. Cylindra's integral, bayonet-mounted accessory holder accommodates up to two accessories simultaneously.

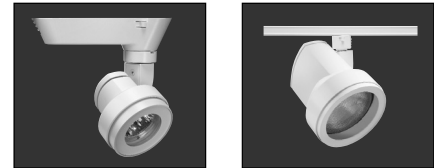

### Low Voltage MR16

**Construction** Die cast aluminum housing.

**Socket** Ceramic bi-pin.

**Accessory Holder** Integral to fixture design • Die cast aluminum construction • Precision bayonet mounting • Accommodates up to two accessories simultaneously • Clear glass lens included with fixture.

**Transformer T537 or T538** 12V solid state electronic transformer with on/off switch • Must be ordered separately • Refer to specification sheet D1.2.1.

**Aiming** 360° horizontal rotation • 90° vertical aiming capability.

**Labels** UL and C-UL Listed.

Product specifications subject to change without notice.

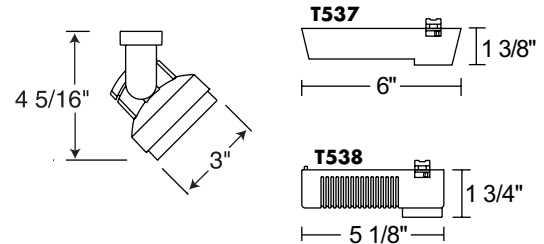

Catalog Number	Finish	Lamp
T841WH	White	20-50W MR16
T841BL	Black	20-50W MR16
T841SL	Silver	20-50W MR16

### ACCESSORIES

Cat. No.	Description	Cat. No.	Description	Cat. No.	Description
T741-6	Color Filters/Lenses	T7477	Prismatic Spread Lens	T7478	Linear Spread Lens
T7401-18	Dichroic Lenses	T7420	Diffuse Spread Lens	T7421	Uniformity Lens
T7422	UV Filter Lens	T7459BL	Hexcell Louver		

See specification sheet D1.2.2 for details.

### Line Voltage PAR20

**Construction** Die cast aluminum housing.

**Socket** Medium base porcelain with nickel plated copper screw shell.

**Adapter** Copper alloy contacts provide precise spring action - no arcing and will not take a set • True, positive electrical ground • On/off switch included • Patented embossed polarity arrows on bottom of adapter • Spring-loaded positive latch with embossed polarity arrows secures trac light to trac • "Pull-up" contact to up position for two-circuit application.

**Accessory Holder** Integral to fixture design • Die cast aluminum construction • Precision bayonet mounting • Accommodates up to two accessories simultaneously.

**Aiming** 345° horizontal rotation • 90° vertical aiming capability.

**Labels** UL and C-UL Listed.

Product specifications subject to change without notice.

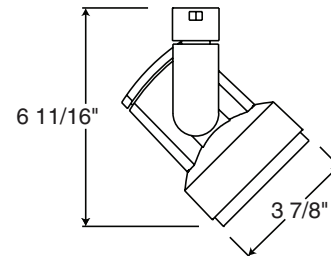

Catalog Number	Finish	Lamp
T844WH	White	35-50W PAR20
T844BL	Black	35-50W PAR20
T844SL	Silver	35-50W PAR20

### ACCESSORIES

Cat. No.	Description	Cat. No.	Description	Cat. No.	Description
T591-6	Color Filters	T597	Prismatic Spread Lens	T598	Linear Spread Lens
T5928BL	Cube Cell Louver	T5918	Dichroic Lens	T5921	Uniformity Lens
T5922	UV Filter				

See specification sheet D1.2.2 for details.

**TRAC-MASTER®**

Avant Garde

**CYLINDRA™ SERIES****T841, T844, T845 and T846****Line Voltage PAR30****Construction** Die cast aluminum housing.**Socket** Medium base porcelain with nickel plated copper screw shell.**Adapter** Copper alloy contacts provide precise spring action - no arcing and will not take a set • True, positive electrical ground • On/off switch included  
• Patented embossed polarity arrows on bottom of adapter • Spring-loaded positive latch with embossed polarity arrows secures trac light to trac  
• "Pull-up" contact to up position for two-circuit application.**Accessory Holder** Integral to fixture design • Die cast aluminum construction  
• Precision bayonet mounting • Accommodates up to two accessories simultaneously.**Aiming** 345° horizontal rotation • 90° vertical aiming capability.**Labels** UL and C-UL Listed.

Product specifications subject to change without notice.

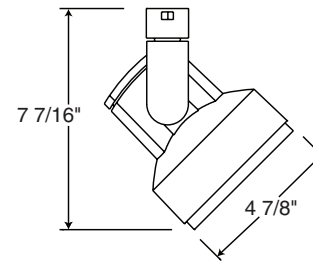

Catalog Number	Finish	Lamp
T845WH	White	50-75W PAR30
T845BL	Black	50-75W PAR30
T845SL	Silver	50-75W PAR30

**ACCESSORIES**

Cat. No.	Description	Cat. No.	Description	Cat. No.	Description
T561-6	Color Filters	T5677	Prismatic Spread Lens	T5678	Linear Spread Lens
T569BL	Cube Cell Louver	T5618	Dichroic Lens	T5621	Uniformity Lens
T5622	UV Filter				

See specification sheet D1.2.2 for details.

**Line Voltage PAR38****Construction** Die cast aluminum housing.**Socket** Medium base porcelain with nickel plated copper screw shell.**Adapter** Copper alloy contacts provide precise spring action - no arcing and will not take a set • True, positive electrical ground • On/off switch included  
• Patented embossed polarity arrows on bottom of adapter • Spring-loaded positive latch with embossed polarity arrows secures trac light to trac  
• "Pull-up" contact to up position for two-circuit application.**Accessory Holder** Integral to fixture design • Die cast aluminum construction  
• Precision bayonet mounting • Accommodates up to two accessories simultaneously.**Aiming** 345° horizontal rotation • 90° vertical aiming capability.**Labels** UL and C-UL Listed.

Product specifications subject to change without notice.

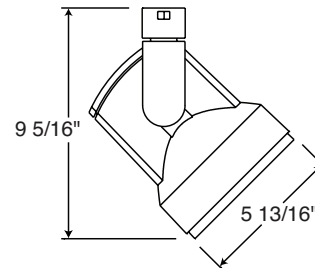

Catalog Number	Finish	Lamp
T846WH	White	45-150W PAR38
T846BL	Black	45-150W PAR38
T846SL	Silver	45-150W PAR38

**ACCESSORIES**

Cat. No.	Description	Cat. No.	Description	Cat. No.	Description
T571-6	Color Filters	T579BL	Cube Cell Louver	T5718	Dichroic Lens
T5721	Uniformity Lens	T5722	UV Filter	T5777	Prismatic Spread Lens
T5778	Linear Spread Lens				

See specification sheet D1.2.2 for details.

